



# COIL LOOP INSERTS

## FLARED COIL THIN SLAB — TECHNICAL DATA SHEET

### **DESCRIPTION:**

Flared Coil Thin Slab Inserts are intended for thin slabs or other conditions where a long coil insert can no longer be used. Insert is Electro-Galvanized.

### **APPLICATION:**

Flared Coil Thin Slab Inserts are typically used for attaching a precast wall panel to a building frame. Inserts must be positioned 1/2" from the surface of the concrete, maintaining at least 3/4" of concrete below the insert. Minimum spacing between inserts is twice the minimum corner distance.

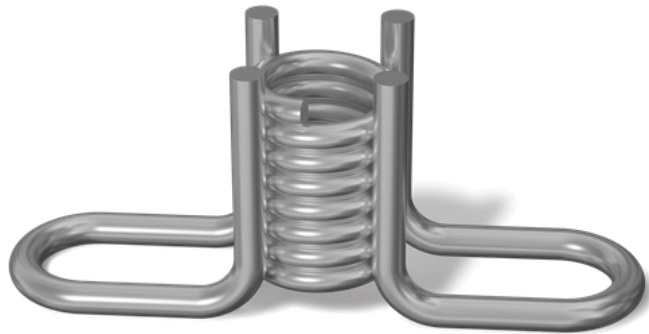

PRODUCT CODE	SIZE	WEIGHT	S.W.L.
CTS012	1/2" x 1-3/4"	26.0 / C	1,520 LBS.
CTS342	3/4" x 2-5/16"	49.0 / C	2,170 LBS.
CTS342CF*	3/4" x 2-5/16"	49.0 / C	2,170 LBS.
CTS343	3/4" x 3-1/2"	87.0 / C	3,570 LBS.
CTS103	1" x 2-5/16"	86.0 / C	2,460 LBS.
CTS104	1" x 4-1/2"	105.0 / C	5,280 LBS.
<b>*CONEFAST STYLE INSERT WITH EXTENDED COIL</b>			
<b>THIS PRODUCT REQUIRES PROPER ENGINEERING</b>			
<b>TENSION LOAD IS APPROX. BASED ON A 4:1 SAFETY FACTOR</b>			

