



# COIL LOOP INSERTS

## FLARED COIL THIN SLAB — TECHNICAL DATA SHEET

### **DESCRIPTION:**

Flared Coil Thin Slab Inserts are intended for thin slabs or other conditions where a long coil insert can no longer be used. Insert is Electro-Galvanized.

### **APPLICATION:**

Flared Coil Thin Slab Inserts are typically used for attaching a precast wall panel to a building frame.

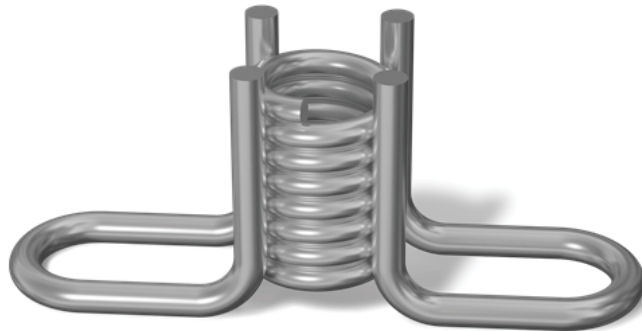

PRODUCT CODE	SIZE	WEIGHT	S.W.L.
CTS012	1/2" X 1-3/4"	26.0 / C	1,520 LBS.
CTS342	3/4" X 2-5/16"	49.0 / C	2,000 LBS.
CTS343	3/4" X 3-1/2"	87.0 / C	3,400 LBS
CTS103	1" X 2-5/16"	86.0 / C	3,400 LBS
CTS104	1" X 4-1/2"	105.0 / C	4,750 LBS.
<b>THIS PRODUCT REQUIRES PROPER ENGINEERING</b>			
<b>TENSION LOAD IS APPROX. BASED ON A 4:1 SAFETY FACTOR</b>			

