



COIL LOOP INSERTS

DOUBLE FLARED COIL LOOP — TECHNICAL DATA SHEET

DESCRIPTION:

Flared Coil Loop Inserts are composed of two Flared Coil Loop Inserts welded perpendicular onto a helix coil. Insert is Electro-Plated.

APPLICATION:

The Criss Cross Flared Coil Loop Insert is effective for low-strength concrete applications. The criss cross design is not intended to straddle reinforcing steel.

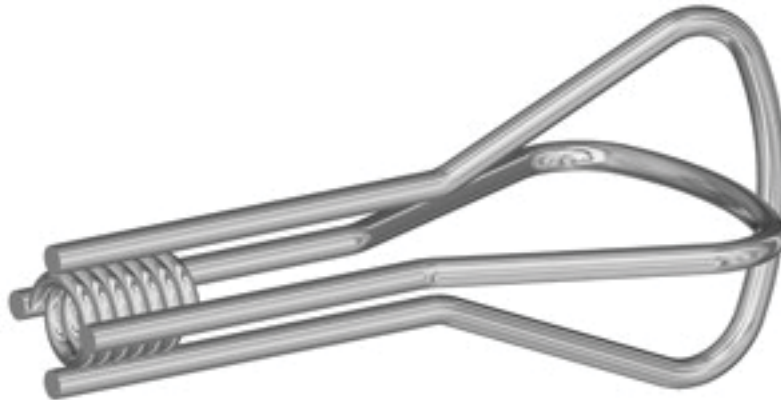

PRODUCT CODE	SIZE	WEIGHT	S.W.L.
CCD10S	1" X 12"	237.0 / C	9,500 LBS
CCD14S	1-1/4" X 12"	245.0 / C	9,500 LBS
CCD12S	1-1/2" X 12"	266.0 / C	9,500 LBS
CCD10H	1" X 12" HVY	312.0 / C	13,500 LBS
CCD14H	1-1/4" X 12" HVY	320.0 / C	13,500 LBS
CCD12H	1-1/2" X 12" HVY	341.0 / C	13,500 LBS
THIS PRODUCT REQUIRES PROPER ENGINEERING			
TENSION LOAD APPROX. BASED ON SAFETY FACTOR OF 4:1			

